



Product Type: LXSC/FX-13D5~25D5 SINGLE JET VANE WHEEL DRY DIAL REMOTE READING WATER

Application:

Measuring the volume of cold potable water passing through the pipeline with remote reading device

Features:

Dry type. small, light, magnetic drive, free rotating register, easy and long term clear reading etc. Magnet resistance. Length of body of 80mm or 110mm is available.

Data Output Options:

10 L/Pulse, 100 L/Pulse, or 1000 L/Pulse

Reed Switch Electric Data

Voltage: 24V AC/DC max.

Current: 0.01A max

Working Condition:

Water temperature:

$\leq 40^{\circ}\text{C}$ for cold potable water meter

$\leq 90^{\circ}\text{C}$ for cold potable water meter

pressure: $\leq 1\text{Mpa}$

Maximum Permissible Error

- a) In the lower zone from Q_{min} inclusive up to but excluding Q_t is: Cold potable and Hot water meter $\pm 5\%$
- b) In the upper zone from Q_t inclusive up to and including Q_s is: Cold potable water meter $\pm 2\%$ Hot water meter $\pm 3\%$

Main Technical Data

Type	Size mm	Class	Qs Max. Flow	Qp Nominal Flow	Qt Transitional Flow	Qmin Min. Flow	Min Reading	Max. Reading
			M ³ /H	L/H	L/H	M ³	M ³	
LXSC-13D5	13	A	3	1.5	150	60	0.001	99999
		B			120	30		
LXSC-20D5	20	A	5	2.5	250	100	0.0001	99999
		B			200	50		
LXSC-25D5	25	A	7	3.5	350	140	0.0001	99999
		B			280	70		

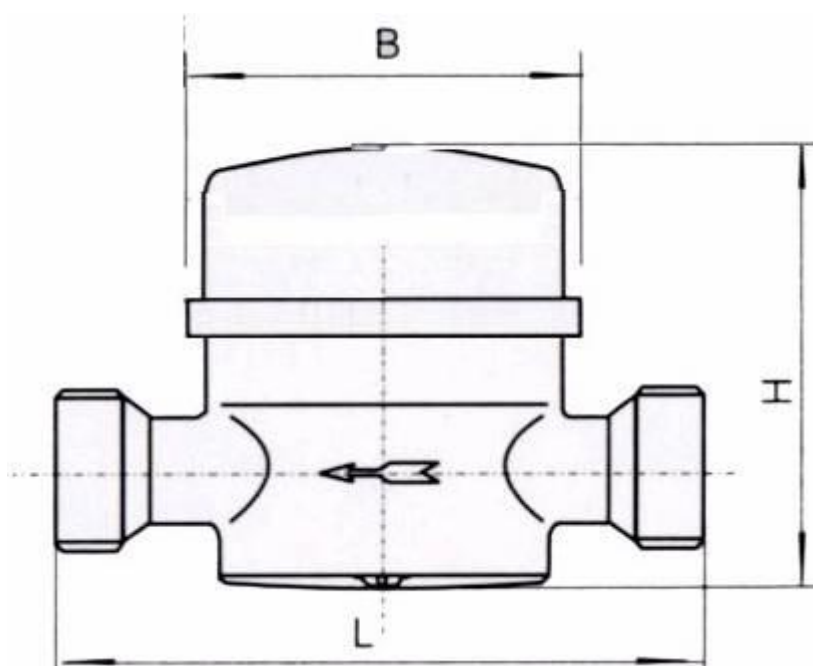

Dimensions and Weight

Type	Size	Length(L)	Width(B)	Height(H)	Connecting Thread(D)	Weight kg
	m/m					
LXSC-13D5	13	110	77	85	G 3/4B	0.80
LXSC-20D5	20	130	77	85	G 1B	0.90
LXSC-25D5	25	160	77	92	G1 1/4B	1.47

性能误差曲线

Flow Error Curve

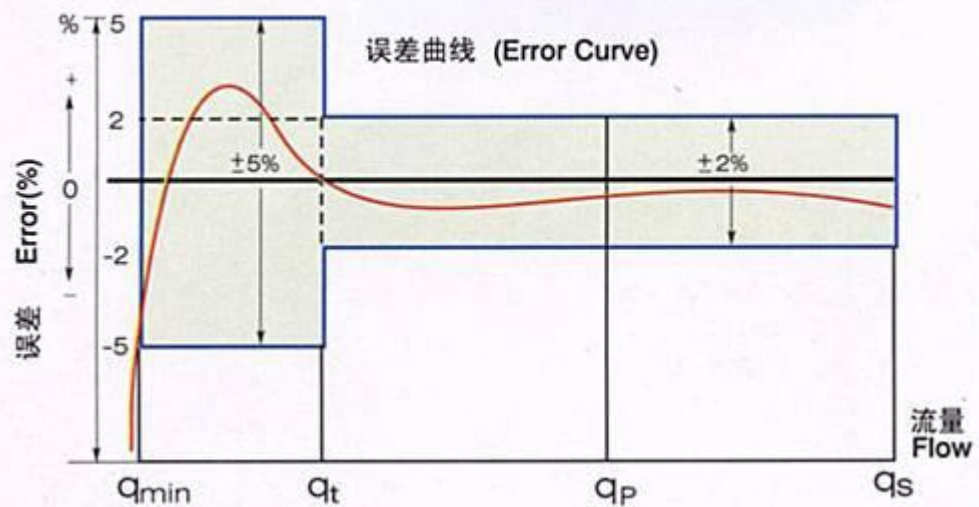

水头损失曲线

Pressure Loss Curve

